



ISO : 9001 : 2015

JAINSONS INDUSTRIES

Brand :
JAINSONS



CE
Approved
GOST
Approved



Ductile Iron Valves (UL & FM Listed)
Y-Type Strainer (UL Listed)



UL/FM listed

Wafer Butterfly
Valve with
Tamper Switch

Test & Drain Valve
(FM listed)



Check out our complete range
online at www.jainsonsindustries.com



COMPANY PROFILE

We use this opportunity to introduce ourselves as a leading Manufacturer & Supplier of G.I. / D.I. Pipe Fittings & Brass Valves for Water Supply, Plumbing, Fire Fighting and Natural Gas Distribution for last 25 years with UL/FM approval.

We are pleased to introduce our UL / FM approved valves as shown in this catalogue from 2" to 12".

- UL / FM approved D.I. Gate valves / Butterfly valves / Check valves.
- D.I. fittings for fire fighting – UL / FM approved for Sprinkler System for Fire Fighting.
- Brass valves – UL Listed, UL / FM approved for Fire Fighting & Plumbing System.
- Malleable Iron Pipe Fittings (ISI Marked) for Plumbing System.
- UL / FM Approved Grooved Fittings.

We wish to get our products approved for your upcoming projects.

We have certification of Bureau of Indian Standards (BIS / ISI). To further certify our quality, the process system as Jainsons Industries are ISO-9001 : 2015 approved.

We also have UL & FM Approved Ductile Iron Pipe Fittings (Grooved and Threaded) for Fire Fighting & Industrial Application.

To add on to our credibility, we are also on the approved vendor list of DMRC, i.e. Delhi Metro Rail Corporation, CIDCO Maharashtra and Bhilai Steel Plant, Bhilai, and many more.

We have supplied Malleable Cast Iron Galvanized Pipe Fittings for Fire Fighting Systems to following sub contractors of DMRC :

- Larsen & Toubro Ltd. (Engineering, Construction & Contracts Division), New Delhi
- Kumagai Skanska HCC Itochu (KSHI) Group (Joint Venture)
- Schwing Setter India Pvt. Ltd., Sriperunpudur (Tamilnadu)

We always take care of on time delivery & quality workmanship to satisfy customer needs.

Please favour us your valuable enquiry for any of our products for quick reply.

For Jainsons Industries

RAJAT JAIN

Mobile : +91-9814-888-333

LIST OF PROJECTS

Our fittings & valves have been recommended by many reputed consultants and have been used in the following Projects, though the actual list is lot longer :

• AIRPORTS

- Aspen Build tech, IGI Airport, Dial Aerocity, New Delhi
- Rajeev Gandhi International Airport Hyderabad, A.P
- Ranchi Airport, Jharkhand
- Raja Bhoj Airport, Bhopal
- Hindon Air Force Station

• HOSPITALS/HEALTHCARE

- Fortis Hospital Gurgaon
- Max Hospital, Shalimar Bagh, New Delhi
- Ashwin's Medical College & Hospitals Pvt. Ltd., Nepal
- Aakash Healthcare Pvt. Ltd., New Delhi
- Glaxo Smith Kline Pharmaceuticals Ltd.,

• PLANTS

- RB Healthcare India Limited, Baddi
- Nayati Healthcare & Research P. Ltd., Mathura
- Hira Hospital, Thane
- Humancare Medical Charitable Trust, Dwarka
- PGD Institute of Medical Education & Research, Chd
- Suasth Hospital, Navi Mumbai

• POWER PROJECTS

- Abir Infrastructure Pvt. Ltd., Chhattisgarh
- NTPC limited, Bihar
- Power Grid Corp. of India Ltd. (Thru L&T), Jind
- Power Grid Corp. of India Ltd. (thru Alstom T&D)
- Aurangabad
- Power Grid Corp. of India Ltd. (thru
- Power Grid Corp. of India Ltd. (thru CGL) Jammu
- Reliance Power Projects, Samalkot
- KSK Power projects, Champa, Chhattisgarh
- Unosugen, Surat
- Larsen & Toubro, Jabalpur
- Suratgarh Super Thermal Power Station, Suratgarh

• RESIDENTIAL

- Omkar 1973 worli, Mumbai
- Green Square Building, Thane
- Samriddhi Building, Thane
- Puri Emerald Bay by Puri Construction, Gurgaon
- Samtanagar Redevelopment Project Infra, Mumbai
- Unitech Ltd. Delhi
- Emerald Bay, Gurgaon by Puri Constructions
- New Cuffe Parade, Wadala

• METRO

- Chennai Metro
- Bangalore Metro
- Delhi Metro
- Lucknow Metro

• HOTELS

- Bhutan Hotels, Thimpu Bhutan
- Holiday INN, Delhi
- Hotel Dan, Bangalore
- Hotel Formulal, Hyderabad
- Hotel Park Plaza, Zirakpur
- Pullman Hotel, IGI Airport, New Delhi
- Sheraton Hotel, Chandigarh
- ITC's Today Hotel Project in Bengaluru & De
- Seven Seas Hotel
- EROS Group's Five Star Hotels in NCR Region
(i) Holiday INN (ii) Mayur Vihar
- Westin Hotel, Gurgaon
- JW Marriot, Aerocity, New Delhi
- Pride Hotel, New Delhi
- Barque Hotel Pvt. Ltd., Chennai
- Lulu Grand Hyattt Hotel & Convention Centre COCHIN
- The Oberoj Sukhvilas Resort, Chandigarh

• BANK

- Barclays Shared Services Pvt. Ltd., Chennai
- Lakshmi Villas Bank Ltd., Chennai
- RBS-Royal Bank of Scotland, Gurgaon

• MALLS

- SLN Terminus, Hyderabad
- R.D.E Mall, Gurgaon

• COMMERCIAL

- Infosys Limited, Chandigarh
- Golden Temple
- IBM India Pvt. Ltd., Navi Mumbai
- Sukham Tower, Bhiwadi
- Bharti Retail Ltd., Hapur
- Indian Institute of Technology, Indore
- ASF Towers, Gurgaon
- Appu Ghar, Gurgaon by International Amusement Limited
- Adobe System India Pvt. Ltd., Noida



Brand : JAINSONS

RANGE OF PRODUCTS



(Z41X) PN10/PN16/PN20

BS Standard **Rising Stem** Flanged Joint Ends (OS&Y Type) Resilient Wedge Gate Valves (Z41X) PN10/PN16/PN20

STATEMENT:

The gate valve can seal flow well with its soft wedge. Where the working temperature is $\leq 80^{\circ}\text{C}$. They are widely used in architectonics, edibles, medicine, chemical energy, supplying and draining water industry, etc. It adjusts the water in piping line and in equipments.

MATERIAL SPECIFICATIONS

Standard:

:BS 5163

Connection Ends:

: BS EN 1092-2

Flange: BS EN 1092-2

Drive Style:

Lever handle

Electric drive

Pneumatic drive

Test Pressure:

PN10 Shell: 1.5MPa Seal: 1.1MPa

PN16 Shell: 2.4MPa Seal: 1.76MPa

PN25 Shell: 3.75MPa Seal: 2.75MPa

Applicable Temperature:

0°C-80°C

Surface:

150-500um, AWWA C550

Coating: Akzo Nobel Fusion Bonded Epoxy
Coating with thickness 150-500um, Complies
with ANSI/AWWA C550.

Applications:

Potable water, water supply and drainage,
sewage disposal, irrigation air condition and fire
protection pipe system etc.

Part No.	Part	Specification
1	Valve Body	Ductile Iron QT450-10
2	Resilient Wedge Disc	Ductile Iron QT450-10/EPDM
3	Stem Back Seat O-Ring	EPDM
4	Stem	Stainless Steel Cr13, 304, 316
5	Nut	Carbon Steel Zinc Plated
6	Bonnet	Ductile Iron QT450-10
7	Stem Bushing	Brass Hpb59-1
8	Gland	Ductile Iron QT450-10
9	Flat Washer	Carbon Steel Zinc Plated
10	Threaded Rod	Carbon Steel Zinc Plated
11	Nut	Carbon Steel Zinc Plated
12	Yoke	Ductile Iron QT450-10
13	Stem Nut	Bronze ZQSn5-5-5 or Brass Hpb59-1
14	Washer	Bronze ZQSn5-5-5 or Brass Hpb59-1
15	Locknut	Malleable Iron KTH300-6 Zinc plated
16	Handwheel	Ductile Iron QT450-10
17	O-Ring	NBR or EPDM
18	Bonnet Gasket	EPDM

Note: The first material is basic configuration. If you have different requirement on accessories, please remark it on inquiry.

Optional accessories: stem nut, electrical drive, pneumatic drive, stem 2Cr13, stem 304, stem 316, bronze stem nut ZQSn5-5-5, brass stem nut Hpb59-1.



Z41X

Flanged OS&Y gate valve



Z81X

Grooved OS&Y gate valve



Z51X

Flanged + Grooved OS&Y gate valve



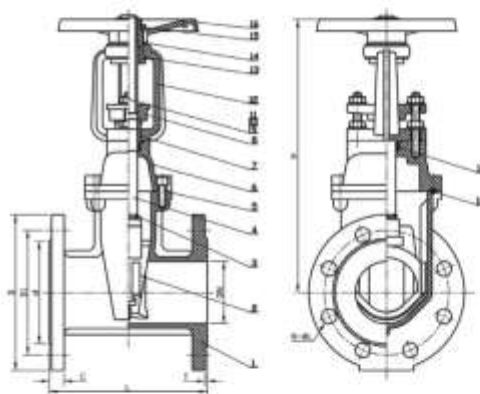
Brand : JAINSONS

FEATURES :

Akzo Nobel Fusion Bonded Epoxy Coating: Inside and Outside, can be used for potable water, food and pharmaceuticals industries with long life.

Material: Ductile Iron Body, Bonnet, Wedge and Handwheel, high strength and corrosion resisting. Valve seat cast with body at the same time, not necessary to machine.

When valve is opened completely, It will have a smooth unobstructed waterway, without groove which will maintain sundries. The same O.D. will not affect fluid medium.



DIMENSIONS

DN		(PN)	Dimensions (mm)								
inch	mm		L	H(close)	H1(open)	D	D1	d	C	T	N-φL
2"	50	10/16	178	257	307	165	125	99	19	3	4-φ19
		25	178	257	307	165	125	99	19	3	4-φ19
2.5"	65	10/16	190	305	370	185	145	118	19	3	4-φ19
		25	190	305	370	185	145	118	19	3	8-φ19
3"	80	10/16	203	350	430	200	160	132	19	3	8-φ19
		25	203	350	430	200	160	132	19	3	8-φ19
4"	100	10/16	229	422	522	220	180	156	19	3	8-φ19
		25	229	422	522	235	190	156	19	3	8-φ23
6"	150	10/16	267	563	713	285	240	211	19	3	8-φ23
		25	267	563	713	300	250	211	20	3	8-φ28
8"	200	10	292	675	875	340	295	266	20	3	8-φ23
		16	292	675	875	340	295	266	20	3	12-φ23
		25	292	675	875	360	310	274	22	3	12-φ28
10"	250	10	330	930	1180	405	350	319	22	3	12-φ23
		16	330	930	1180	405	355	319	22	3	12-φ28
		25	330	930	1180	425	370	330	24.5	3	12-φ31
12"	300	10	356	1050	1350	460	400	370	24.5	4	12-φ23
		16	356	1050	1350	460	410	370	24.5	4	12-φ28
		25	356	1050	1350	485	430	389	27.5	4	16-φ31

(Z41X) 300PSI (PN20)

American Standard Rising Stem Flanged Joint Ends (OS&Y Type) Resilient Wedge Gate Valves (Z41X) 250PSI/300PSI

STATEMENT:

The gate valve can seal flow well with its soft wedge. Where the working temperature is $\leq 80^{\circ}\text{C}$. They are widely used in architectonics, edibles, medicine, chemical energy, supplying and draining water industry, etc. It adjusts the water in piping line and in equipments.

MATERIAL SPECIFICATIONS

Standard:

AWWA C515

Connection Ends:

ASME B16.1

Flange : ASME B16.1

Drive Style:

Lever handle

Electric drive

Pneumatic drive

Test Pressure:

250PSI Shell:500PSI Seal:250PSI

300PSI Shell:600PSI Seal:300PSI

Applicable Temperature:

0°C-80°C

Surface:

150-500um, AWWA C550

Coating: Akzo Nobel Fusion Bonded Epoxy

Coating with thickness 150-500um, Complies with ANSI/AWWA C550.

Applications:

Potable water, water supply and drainage, sewage disposal, irrigation air condition and fire protection pipe system etc.

Part No.	Part	Specification
1	Valve Body	Ductile Iron QT450-10
2	Resilient Wedge Disc	Ductile Iron QT450-10/EPDM
3	Stem	Stainless Steel Cr13,304,316
4	Bonnet Gasket	EPDM
5	Bonnet	Ductile Iron QT450-10
6	O-Ring	NBR or EPDM
7	Yoke	Ductile Iron QT450-10
8	Stem Bushing	Hpb59-1
9	Gland	Ductile Iron QT450-10
10	Stem Nut	Bronze ZQSn5-5-5 or Brass Hpb59-1
11	Handwheel	Ductile Iron QT450-10
12	Washer	Bronze ZQSn5-5-5 or Brass Hpb59-1
13	Nut	Carbon Steel Zinc Plated
14	Threaded Rod	Carbon Steel Zinc Plated
15	Flat Washer	Carbon Steel Zinc Plated
16	Bolt	Carbon Steel Zinc Plated
17	Stem Back Seat O-Ring	EPDM

Note: The first material is basic configuration. If you have different requirement on accessories, please remark it on inquiry.

Optional accessories: electrical drive, pneumatic drive, stem 2Cr13, stem 304, stem 316, bronze stem nut ZQSn5-5-5, brass stem nut Hpb59-1.



Z41X

Flanged OS&Y gate valve



Z81X

Grooved OS&Y gate valve



Z51X

Flanged + Grooved OS&Y gate valve



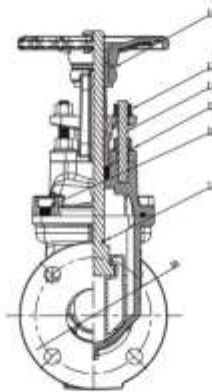
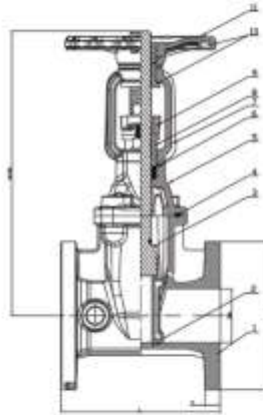
Brand : JAINSONS

FEATURES :

Akzo Nobel Fusion Bonded Epoxy Coating: Inside and Outside, can be used for potable water, food and pharmaceuticals industries with long life.

Material: Ductile Iron Body, Bonnet, Wedge and Handwheel, high strength and corrosion resisting. Valve seat cast with body at the same time, not necessary to machine.

When valve is opened completely, It will have a smooth unobstructed waterway, without groove which will maintain sundries. The same O.D. will not affect fluid medium.



DIMENSIONS

DN		Dimensions(mm)						
inch	mm	L	H(open)	H1(close)	D	D1	C	n-φL
2"	50	178	370	318	152	102.7	16	4-φ19.1
2.5"	65	190	410	343	178	139.7	17.5	4-φ19.1
3"	80	203	468	386	191	152.4	19	8-φ19.1
4"	100	229	538	436	229	190.5	19	8-φ19.1
5"	125	254	640	513	254	215.9	19.1	8-φ22.2
6"	150	267	730	576	279	241.3	19.1	8-φ22.2
8"	200	292	950	749	343	298.5	22.2	8-φ22.2
10"	250	330	1158	904	406	362	23.8	12-φ25.4
12"	300	356	1335	1030	483	431.8	25.4	12-φ25.4

(Z45X) PN10/PN16

BS Standard **Non-Rising Stem** Resilient Wedge Gate Valves Type A T key (Z45X) PN10/PN16

STATEMENT :

The gate valve can seal flow well with its soft wedge. Where the working temperature is $\leq 80^{\circ}\text{C}$. They are widely used in architectonics, edibles, medicine, chemical energy, supplying and draining water industry, etc. It adjusts the water in piping line and in equipments.

MATERIAL SPECIFICATIONS

Standard:

:BS 5163

Connection Ends:

: BS EN 1092-2

Flange: BS EN 1092-2

Drive Style:

Lever handle

Electric drive

Pneumatic drive

Test Pressure:

PN10 Shell: 1.5MPa Seal: 1.1MPa

PN16 Shell: 2.4MPa Seal: 1.76MPa

PN25 Shell: 3.75MPa Seal: 2.75MPa

Applicable Temperature:

0°C-80°C

Surface:

150-500um, AWWA C550

Coating: Akzo Nobel Fusion Bonded Epoxy
Coating with thickness 150-500um, Complies with ANSI/AWWA C550.

Applications:

Potable water, water supply and drainage, sewage disposal, irrigation air condition and fire protection pipe system etc.

Note: The first material is basic configuration. If you have different requirement on accessories, please remark it on inquiry. Optional accessories: stem nut, electric drive, pneumatic drive, stem 2Cr13, stem 304, stem 316, brass thrust washer H62, brass thrust washer Hpb59-1, Indicator.

Part No.	Part	Specification
1	Valve Body	Ductile Iron QT450-10
2	Resilient Wedge Disc	Ductile Iron QT450-10/EPDM
3	Stem	Stainless Steel Cr13,304,316
4	Nut	Carbon Steel Zinc Plated
5	Bonnet	Ductile Iron QT450-10
6	O-Ring	NBR or EPDM
7	Gland Flange	Ductile Iron QT450-10
8	Handwheel	Ductile Iron QT450-10
9	Bolt	Carbon Steel Zinc Plated
10	Flat Washer	Carbon Steel Zinc Plated
11	Ring Wiper	NBR or EPDM
12	Bolt	Carbon Steel Zinc Plated
13	Flat Washer	Carbon Steel Zinc Plated
14	O-Ring	NBR or EPDM
15	Thrust Washer	Brass H62 or Hpb59-1
16	Bonnet Gasket	EPDM
17	Wedge Nut	Bronze ZQSn5-5-5
18	Indicator Board	Carbon Steel
19	Pointer	Cast Aluminum
20	Screw	Carbon Steel



Z45X

Flanged non-rising stem gate valve with wheel and indicator



Z45XC

Flanged non-rising stem gate valve with stem cap



Z35X

Mechanical joint non-rising stem gate valve with wheel



Z85X

Grooved non-rising stem gate valve with wheel



Brand : JAINSONS

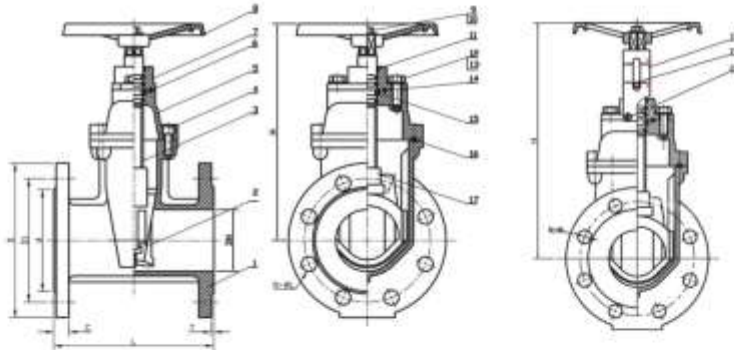
FEATURES :

Akzo Nobel Fusion Bonded Epoxy Coating : Inside and Outside, can be used for potable water, food and pharmaceuticals industries with long life.

Material : Ductile Iron Body, Bonnet, Wedge and Handwheel, high strength and corrosion resisting. Valve seat cast with body at the same time, not necessary to machine.

Triple O-Ring stem seals make valves having axial self seals without the trouble of packing seal adjustment. The ring wiper can stop impurity going into shaft seal.

When valve is opened completely, It will have a smooth unobstructed waterway, without groove which will maintain sundries. The same O.D. will not affect fluid medium.



DIMENSIONS

DN		PN	Dimensions (mm)							
inch	mm		L	H	D	D1	d	C	T	N-φ L
2"	50	10/16	178	218	165	125	99	19	3	4-φ 19
		25	178	218	165	125	99	19	3	4-φ 19
2.5"	65	10/16	190	230	185	145	118	19	3	4-φ 19
		25	190	230	185	145	118	19	3	8-φ 19
3"	80	10/16	203	281	200	160	132	19	3	8-φ 19
		25	203	281	200	160	132	19	3	8-φ 19
4"	100	10/16	229	316	220	180	156	19	3	8-φ 19
		25	229	316	235	190	156	19	3	8-φ 23
6"	150	10/16	267	420	285	240	211	19	3	8-φ 23
		25	267	420	300	250	211	20	3	8-φ 28
8"	200	10	292	490	340	295	266	20	3	8-φ 23
		16	292	490	340	295	266	20	3	12-φ 23
		25	292	490	360	310	274	22	3	12-φ 28
10"	250	10	330	680	405	350	319	22	3	12-φ 23
		16	330	680	405	355	319	22	3	12-φ 28
		25	330	680	425	370	330	24.5	3	12-φ 31
12"	300	10	356	740	460	400	370	24.5	4	12-φ 23
		16	356	740	460	410	370	24.5	4	12-φ 28
		25	356	740	485	430	389	27.5	4	16-φ 31
14"	350	10	381	800	505	460	429	24.5	4	16-φ 23
		16	381	800	520	470	429	26.5	4	16-φ 28
		25	381	800	555	490	448	30	4	16-φ 34
16"	400	10	406	870	565	515	429	24.5	4	16-φ 28
		16	406	870	580	525	480	28	4	16-φ 31
		25	406	870	620	550	503	32	4	16-φ 37

FLANGED RESILIENT NRS

Gate Valve, with Post Flange (Z45XC-2)

PN10/16, UL/FM Approved



Z45XC-2

Connection Ends :

Flange to BS EN 1092-2:1997

Working Pressure :

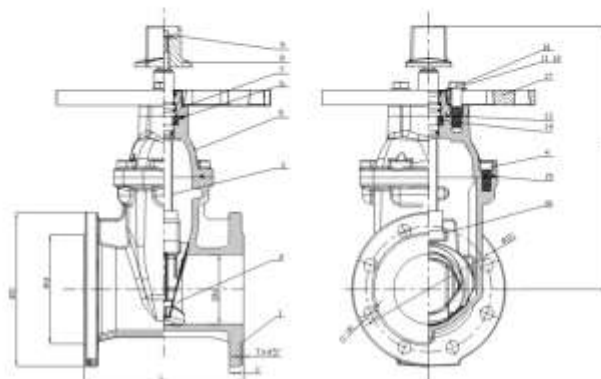
PN10/16

Temperature Range :

0° - 80°

Coating :

Fusion Bonded Epoxy Coating in accordance with ANSI/AWWA C550



MATERIAL SPECIFICATIONS

Part No.	Part	Standard Specification	Options
1	Valve Body	EN-GJS-450-10	
2	Resilient Wedge Disc	EN-GJS-450-10+EPDM	
3	Stem	SS420 (Type A), SS431 (Type B)	SS304, SS316, SS420, SS431, Al-bronze
4	Bolt	Carbon Steel Zinc Plated	SS304, SS316
5	Bonnet	EN-GJS-450-10	
6	O-Ring	NBR	EPDM
7	Gland	EN-GJS-450-10	
8	Stem Cap	EN-GJS-450-10	
9	Bolt	Carbon Steel Zinc Plated	SS304, SS316
10	Ring Wiper	NBR	
11	Bolt	Carbon Steel Zinc Plated	SS304, SS316
12	Flat Washer	Carbon Steel Zinc Plated	SS304, SS316
13	O-Ring	NBR	EPDM
14	Thrust Washer	Brass HPb59-1 (Type A) Not Available (Type B)	
15	Bonnet Gasket	EPDM	NBR
16	Wedge Nut	Brass HPb59-1	Bronze ZQSn5-5-5
17	Post Flange	EN-GJS-450-10	

Note: For special material request other than standard specification, please indicate clearly on the inquiry or order list.

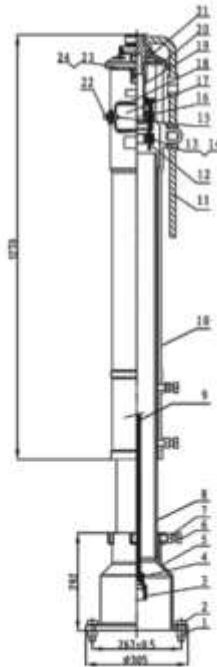
DN		PN	Dimensions(mm)								
Inch	mm		L	H		D	D1	d	C	T	n-d
				TypeA	TypeB						
4"	100	10/16	229	347	395	220	180	156	19	3	8-Φ19
5"	125	10/16	254	432	432	250	210	184	19	3	8-Φ19
6"	150	10/16	267	443	475	285	240	211	19	3	8-Φ23
8"	200	10	292	518	585	340	295	266	20	3	8-Φ23
		16									12-Φ23
10"	250	10	330	656	656	405	350	319	22	3	12-Φ23
		16					355				12-Φ28
12"	300	10	356	751	751	460	400	370	24.5	4	12-Φ23
		16					410				12-Φ28



Brand : JAINSONS

VERTICAL INDICATOR POST (IP)

UL/FM Approved



IP

Statement:

Vertical indicator post provides a means to operate a buried or otherwise inaccessible valve and able to indicate the open or shut position of the valve.

Coating:

Fusion Bonded Epoxy Coating in accordance with ANSI/AWWA C550

Field Adjustment:

1. Remove the Top Section from the top of the Indicator Post assembly;
2. Cut the required stem length and adjust the Standpipe to match up to the ground line;
3. Set the "OPEN" and "SHUT" targets for the appropriate valve size;
4. Reattach the Top Section to the top of the Indicator Post assembly.

MATERIAL SPECIFICATIONS

Part No.	Part	Standard Specification
1	Hex Nut	Carbon Steel Zinc Plated
2	Hex Bolt	Carbon Steel Zinc Plated
3	Socket	EN-GJS-450-10
4	Cotter Pin	SS304
5	Base Flange	Cast Iron EN-GJL-200
6	Hex Bolt	Carbon Steel Zinc Plated
7	Hex Nut	Carbon Steel Zinc Plated
8	Standpipe	Carbon Steel
9	Stem 1" Square	Carbon Steel
10	Body	Cast Iron EN-GJL-200
11	Locking Wrench	EN-GJS-450-10
12	Target Carrier Nut	Cast Aluminum
13	Hex Bolt	Carbon Steel Zinc Plated
14	Hex Nut	Carbon Steel Zinc Plated
15	Hex Bolt	Carbon Steel Zinc Plated
16	Target	Cast Aluminum
17	Window Glass	Plexiglass
18	Gasket	EPDM
19	Operating Nut	SS304
20	Top Section	Cast Iron EN-GJL-200
21	Snap Ring	Spring Steel
22	Plug	Malleable Iron
23	Square Nut	Carbon Steel Zinc Plated
24	Hex Bolt	Carbon Steel Zinc Plated

(D71X) PN20/PN16

Wafer Butterfly Valves (D71X) PN20/PN16

CE Approved
GOST Approved

STATEMENT:

The valve is widely applied to cut off fluid in piping system. It can also be designed, however, to act as adjusting valve or with both functions.

MATERIAL SPECIFICATIONS

Standard:

: BS 5155

: ISO 5211

Top flange standard : ISO 5211

Drive Style:

Lever handle

Gear handle

Electric drive

Pneumatic drive

Test Pressure:

PN6 Shell: 0.9MPa Seal: 0.66MPa

PN10 Shell: 1.5MPa Seal: 1.1MPa

PN16 Shell: 2.4MPa Seal: 1.76MPa

Applicable Temperature:

0°C-80°C

Surface:

150-500um, AWWA C550

Coating: Akzo Nobel Fusion Bonded Epoxy

Coating with thickness 150-500um, Complies with ANSI/AWWA C550.

Applications:

Potable water, water supply and drainage, sewage disposal, irrigation and fire protection pipe system etc.

Part No.	Part	Specification
1	Value Body	Ductile Iron QT450-10
2	Disc	Ductile Iron QT450-10 Zinc Plated Ductile Iron QT450-10 Nickel Plated Stainless Steel CF8 Carbon Steel Stainless Steel CF8M
3	Stem	Stainless Steel
4	Bushing	NYLON 1010
5	Rubber Seat	EPDM NBR



D71X
Wafer butterfly valve
lever handle



D371X
Wafer butterfly valve
gear handle



D971X
Wafer butterfly valve
electric drive



D671X
Wafer butterfly valve
pneumatic drive



Brand : JAINSONS

FEATURES :

Small size with light weight design, easy installation and maintenance wherever required.

Simple and compact construction, quick 90 degrees on-off operation. When it's closed, no leakage under pressure testing.

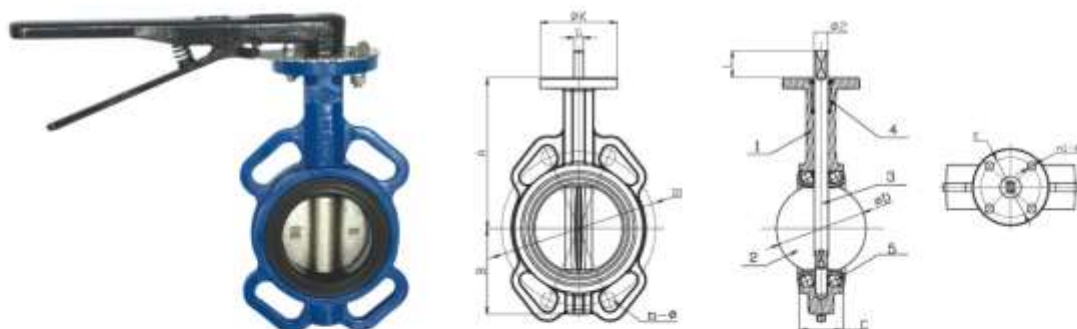
Minimized operating torque, light force required during operating.

Flow curve tending to straight line. Excellent regulating performance.

- Long service life, capable of withstanding 10,000 times of on-off testing.
- Widely used for various medium with different accessories.

Akzo Nobel Fusion Bonded Epoxy Coating: Inside and Outside, can be used for potable water, food and pharmaceuticals industries with long life.

CE Approved
GOST Approved



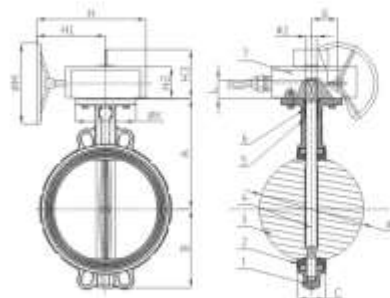
DIMENSIONS

DN		Dimensions (mm)													
inch	mm	A	B	C	D	D1		L	K	E	Φ2	n1-Φ1	n-Φ		G
						1.0	1.6						1.0	1.6	
2"	50	140.5	64.5	43	53.9	125	125	32	90	70	14	4-Φ10	4-Φ19	4-Φ19	9.53
2.5"	65	153	72	46	65.2	145	145	32	90	70	14	4-Φ10	4-Φ19	4-Φ19	9.53
3"	80	153	86	46	79.7	160	160	32	90	70	14	4-Φ10	8-Φ19	8-Φ19	9.53
4"	100	176	100	52	105	180	180	32	90	70	16	4-Φ10	8-Φ19	8-Φ19	11.14
5"	125	191	112	56	130	210	210	32	90	70	16	4-Φ10	8-Φ19	8-Φ19	11.14
6"	150	202.5	128	56	155.8	240	240	32	90	70	20	4-Φ10	8-Φ23	8-Φ23	12.7
8"	200	243.5	162	60	206.7	295	295	45	125	102	26	4-Φ12	8-Φ23	12-Φ23	20.6
10"	250	273	194	68	253.25	350	355	45	125	102	26	4-Φ12	12-Φ23	12-Φ28	20.6
12"	300	311	223	78	301.85	400	410	45	125	102	28	4-Φ12	12-Φ23	12-Φ28	22.1
14"	350	368	267	76.5	333.3	460	470	45	125	102	31.6	4-Φ12	16-Φ23	16-Φ28	22.1
16"	400	400	307	86.5	389.6	515	525	51.2	175	140	33.15	4-Φ18	16-Φ28	16-Φ31	22.1
18"	450	422	328	105.6	440.5	565	585	51.2	175	140	38	4-Φ18	20-Φ28	20-Φ31	27
20"	500	480	361	131.8	491.6	620	650	64.2	175	140	41.15	4-Φ18	20-Φ28	20-Φ34	27
24"	600	562	459	152	592.5	725	770	70.2	210	165	50.65	4-Φ22	20-Φ31	20-Φ37	36
28"	700	624	520	163	695	840	840	66	300	254	63.5	4-Φ18	24-Φ31	24-Φ37	46
32"	800	672	591	188	794.7	950	950	66	300	254	63.5	4-Φ18	24-Φ34	24-Φ41	46
36"	900	720	656	203	864.7	1050	1050	118	300	254	75	4-Φ18	28-Φ34	28-Φ41	55
40"	1000	800	721	216	965	1160	1170	253	300	254	85	4-Φ18	28-Φ37	28-Φ44	55

WAFER BUTTERFLY VALVE

with Tamper Switch

(XD371X), PN10/PN16



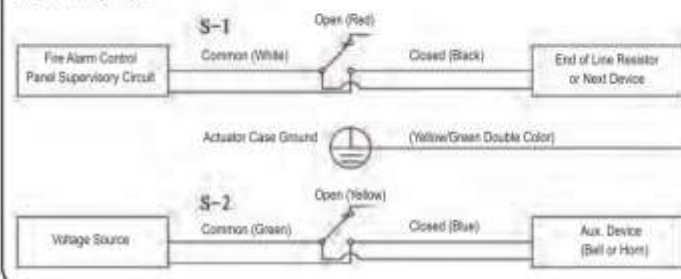
MATERIAL SPECIFICATIONS

Part No.	Part	Standard Specification	Options
1	Valve Body	EN-GJS-450-10	
2	Seat	EPDM & Backing	NBR / Fluororubber & Backing EPDM / NBR Vulcanized on Valve Body Soft Seat in EPDM / NBR
3	Disc	EN-GJS-450-10	SS304, SS316, AL-Bronze C95400
4	Stem	SS420, One-Piece Stem Design	SS304, SS316, SS416, SS431
5	O-Ring	NBR	EPDM
6	Bushing	PTFE	Nylon 1010
7	Signal Gear Box	EN-GJS-450-10	

Note : For special material request other than standard specification please indicate clearly on the inquiry or order list.

- **Design Standard :** BS EN 593
- **Connection Ends :** BS EN 1092 PN10/PN16, AS 2129 TABLE E, JIS B2212 10K, BS 10 TABLE D/E
- **Top Flange Standard :** ISO 5211
Stem drive by keys, parallel or diagonal square or flat head
- **Working Pressure :** PN10/16
- **Temperature Range :** 0°C-80°C
- **Coating :** Fusion Bonded Epoxy Coating in accordance with ANSI/AWWA C550

SWITCH WIRING DIAGRAM



DN		Dimensions (mm)													
Inch	mm	A	B	M	H	H1	H2	H3	K	G	ØD	C	Ø2	L	ISO 5211
2"	50	140.5	64.5	150	208	151	65	108	90	59	53.9	43	14	32	F07
2.5"	65	153	72	150	208	151	65	108	90	59	65.2	46	14	32	F07
3"	80	157.5	86	150	208	151	65	108	90	59	79.7	46	14	32	F07
4"	100	176	100	150	208	151	65	108	90	59	105	52	16	32	F07
5"	125	191	112	150	208	151	65	108	90	59	130	56	16	32	F07
6"	150	202.5	128	150	208	151	65	108	90	59	156	56	20	32	F07
8"	200	243.5	162	200	298	223	77	121	125	75	207	60	26	45	F10
10"	250	273	194	200	298	223	77	121	125	75	253.3	68	26	45	F10
12"	300	311	223	250	299	224	77	121	125	75	301.9	78	26	45	F10

**(H44X/H44T) PN10/PN16**BS Standard **Swing** Check Valves Flanged Joint Ends, Rubber Seal (H44X) / Metal Seal (H44T) PN10/PN16/PN25**STATEMENT:**

Usage: It can prevent the water from flowing backward.

MATERIAL SPECIFICATIONS**Standard:**

: BS EN 12334

Connection Ends:

: BS EN 1092-2

Flange : BS EN 1092-2

Rubber Seal:**Test Pressure:**

PN10 Shell:1.5MPa Seal:1.1MPa

PN16 Shell:2.4MPa Seal:1.76MPa

PN25 Shell:3.75MPa Seal:2.75MPa

Applicable Temperature:

0°C-80°C

Metal Seal:**Test Pressure:**

PN10 Shell:1.5MPa Seal:1.1MPa

PN16 Shell:2.4MPa Seal:1.76MPa

PN25 Shell:3.75MPa Seal:2.75MPa

Applicable Temperature:

-10°C-80°C

Surface:

150-500um, AWWA C550

Coating: Akzo Nobel Fusion Bonded Epoxy

Coating with thickness 150-500um, Complies with ANSI/AWWA C550.

Applications:

Potable water, water supply and drainage, sewage disposal, irrigation and fire protection steam and oil pipe system etc.

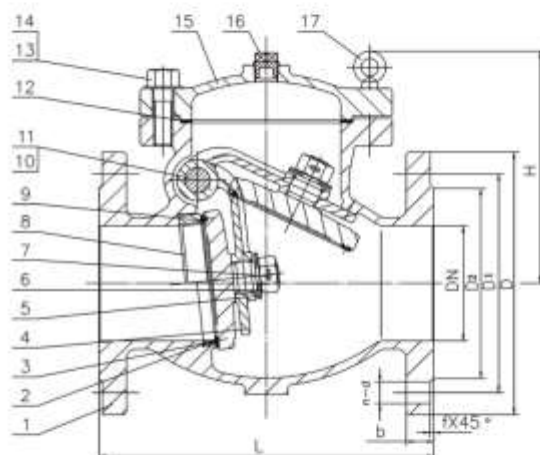
Part No.	Part	Specification
1	Valve Body	Ductile Iron QT450-10
2	Seat Ring (Press Fit)	ASTM B62 or 13Cr
3	Disc	Ductile Iron QT450-10 and EPDM Ductile Iron QT450-10 and Seat Ring
4	Hinge	Ductile Iron QT450-10
5	Washer	Stainless Steel 13Cr
6	Nut	Carbon Steel Zinc Plated
7	Split Pin	Stainless Steel 304
8	Seat Ring Threaded	Brass ASTM B62 or Stainless Steel 13Cr
9	Disc Seal Ring	ASTM B62 or 13Cr
10	Hinge Pin	Stainless Steel 13Cr
11	Plug	Malleable Iron Galvanized
12	Bonnet Gasket	Graphite + Steel EPDM
13	Bolts	Carbon Steel Zinc Plated
14	Washer	Carbon Steel Zinc Plated
15	Bonnet	Ductile Iron QT450-10
16	Plug	Malleable Iron Galvanized
17	Sling Ring	Carbon Steel Zinc Plated

Swing Check Valve FM Approved

FEATURES :

Light body, short on & off distance for disc, small flow resistance.

Valve can be stopped quickly with good energy-saving results.



DIMENSIONS

DN		PN	Dimensions (mm)							
inch	mm		L	D	D1	D2	b	n-d	f	H
2"	50	10/16/25	203	165	125	99	19	4-19	3	146
2.5"	65	10/16/25	216	185	145	118	19	4-19	3	155
3"	80	10/16/25	241	200	160	132	19	8-19	3	173
4"	100	10/16	292	220	180	156	19	8-19	3	180
		25	292	235	190	156	19	8-23	3	180
5"	125	10/16	330	250	210	184	19	8-19	3	212
		25	330	270	220	184	19	8-23	3	212
6"	150	10/16	356	285	240	211	19	8-23	3	260
		25	356	300	250	211	20	8-28	3	260
8"	200	10	495	340	295	266	20	8-23	3	290
		16	495	340	295	266	20	12-23	3	290
		25	495	360	310	274	22	12-28	3	290
10"	250	10	622	405	350	319	22	12-23	3	339
		16	622	405	355	319	22	12-28	3	339
		25	622	425	370	330	24.5	12-31	3	339
12"	300	10	698	460	400	370	24.5	12-23	4	376
		16	698	460	410	370	24.5	12-28	4	376
		25	698	485	430	389	27.5	16-31	4	376



Brand : JAINSONS

(DH77X) PN10/PN16

BS Standard Wafer Butterfly-type Check Valves (DH77X) PN10/PN16

STATEMENT:

The valve can be used on pipe line through which water $\leq 80^{\circ}\text{C}$ or other noncorrosive medium to prevent back flow.

MATERIAL SPECIFICATIONS

Standard:

: BS EN 1074-3

Test Pressure:

PN10 Shell:1.5MPa Seal:1.1MPa

PN16 Shell:2.4MPa Seal:1.76MPa

Applicable Temperature:

0°C-80°C

Surface:

150-500um, AWWA C550

Coating: Akzo Nobel Fusion Bonded Epoxy
Coating with thickness 150-500um, Complies
with ANSI/AWWA C550.

Applications:

To prevent the medium regorging and diminish
noises of potable water, water supply and
drainage, sewage disposal, irrigation and fire
protection pipe system etc.

Part No.	Part	Specification
1	Valve Body	Ductile Iron QT450-10
2	Disc	Ductile Iron QT450-10 Zinc Plated or Stainless Steel 304
3	Stem	Stainless Steel
4	Spring	Stainless Steel
5	Rubber Seat	EPDM or NBR

Optional accessories: ductile iron disc or stainless steel 304 disc.

FEATURES :

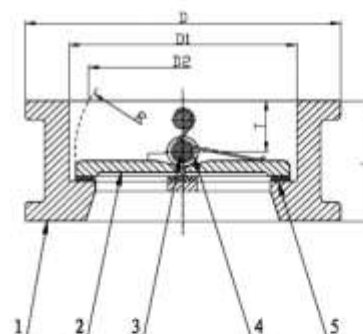
Accelerate closing by lighter body design and use of spring, can reduce the water hammer and sound.

Short distance between valve's surface than the general check valve makes installation becoming easier in the limit space.

Small size, light weight, reasonable constructure, easy maintenance.

Can be installed in horizontal or vertical direction pipeline. The valve stem should be perpendicular to the flow direction when installed into horizontal pipeline. On vertical pipeline, the flow direction should be from the bottom to up.

Akzo Nobel Fusion Bonded Epoxy Coating: Inside & Outside, can be used for potable water, food and pharmaceuticals industries with long life.



DIMENSIONS

DN		PN	Dimensions (mm)					
inch	mm		L	D	D1	D2	R	t
2"	50	PN10/16	54	107	64	41.6	28.5	19.5
2.5"	65	PN10/16	54	127	78	36.6	36	31
3"	80	PN10/16	57	142	94	67.5	42	25
4"	100	PN10/16	64	162	117	83.5	50	27.5
5"	125	PN10/16	70	192	145	116	66	31.5
6"	150	PN10/16	76	218	170	140.5	77	31.5
8"	200	PN10/16	95	273	224	189.2	102.5	39.5
10"	250	PN10/16	108	328	265	233.7	125	44.5
12"	300	PN10/16	143	378	310	203.6	146	72.5
14"	350	PN10/16	127	438	360	327.87	170	45
16"	400	PN10/16	140	489	410	375.88	195	52
18"	450	PN10/16	152	555	450	414.06	215	58
20"	500	PN10/16	152	594	505	467.83	241	58
24"	600	PN10/16	178	700	624	569.59	294	73

Note : Not designed for dead end service



Brand : JAINSONS

FLANGED Y-TYPE STRAINER (V4), PN10/16, UL Listed

MATERIAL SPECIFICATIONS

Part No.	Part	Standard Specification	Options
1	Valve Body	EN-GJS-450-10	
2	Screen	SS304 (Perforated)	SS304, SS316 (Perforated, Knitted, Double Screen)
3	Gasket	Graphite+Acanthopore Plate	EPDM
4	Bonnet	EN-GJS-450-10	
5	Plug	Malleable Iron Galvanized	Bronze ASTM B584
6	Bolt	Carbon Steel Zinc Plated	SS304, SS316
7	Flat Washer	Carbon Steel Zinc Plated	SS304, SS316

STANDARD SCREEN

DN		Sieve No.	Hole Dia.	Free Flow Area (%)
Inch	mm		mm	%
2"-2.5"	50-65	25	4	48
3"-4"	80-100	19	5	59
5"	125	14	6	63
6"-12"	150-300	13	6.3	64

Note : For special material request other than standard specification, please indicate clearly on the inquiry or order list.

DN		PN	Dimensions (mm)							
Inch	mm		L	D	D1	D2	b	n-Φd	f	H
2"	50	10/16	230	165	125	99	19	8-Φ19	3	140
2.5"	65	10/16	290	185	145	118	19	4-Φ19	3	175
3"	80	10/16	310	200	160	132	19	8-Φ19	3	198
4"	100	10/16	350	220	180	156	19	8-Φ19	3	229
5"	125	10/16	400	250	210	184	19	8-Φ19	3	287
6"	150	10/16	480	285	240	211	19	8-Φ23	3	304
8"	200	10	600	340	295	266	20	8-Φ23	3	370.5
		16						12-Φ23		
10"	250	10	730	405	350	319	22	12-Φ23	3	469
		16			355			12-Φ28		
12"	300	10	850	460	400	370	24.5	12-Φ23	4	540
		16			410			12-Φ28		

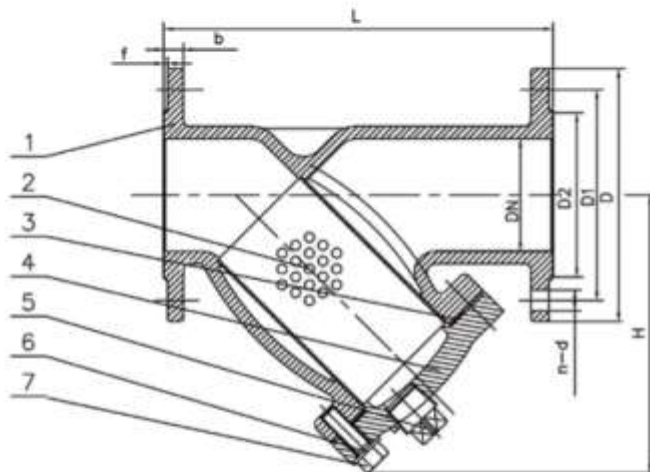
Y-TYPE STRAINER

STATEMENT :

Installed before relief valves, atmospheric valves, hydraulic control valves as well as other equipments, strainers serve to filter out the impurities in the flow medium for protection of valves and equipments in the piping system.

FEATURES :

- Material : Ductile Iron EN-GJS-450-10
- Valve body and cover are produced in ductile iron material which provides guarantee for high strength and good corrosion resistance.
- Different Options of Screen Mesh Specification
Different Options of screen mesh specification available as per different service conditions.
- Fusion Bonded Epoxy Coating - Fusion bonded epoxy coating in accordance with ANSI/AWWA C550 for both interior and exterior surface which provides reliable corrosion resistance.



V8
Grooved T-Type Strainer



V4
Flanged Y-Type Strainer



- Ductile Iron Body & Bonnet
- Stainless Steel Screen
- Fusion Bonded Epoxy Coating
- Gasket : EPDM or Graphite + Acanthopore Plate

Flanged Y-Type Strainer (V4),
PN10/16, UL Listed



- Connection Ends : Flange to BS EN 1092-2 : 1997
- Working Pressure : PN10/16
- Temperature Range : 10°C-200°C Graphite gasket 0°C-80°C rubber gasket
- Coating : Fusion Bonded Epoxy Coating in accordance with ANSI/AWWA C550



Brand : JAINSONS

MODEL UNIVERSAL TEST AND DRAIN (UTD)

Say Bye to Test & Drain Assembly

Approvals: FM

Maximum System Working Pressure: 300 psi (20.6 Bar)

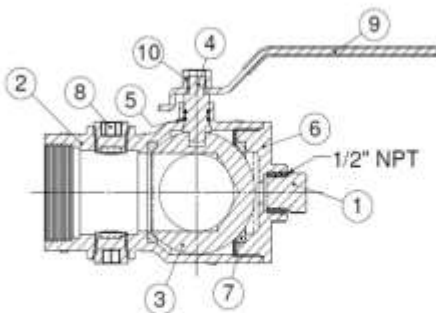
Materials of Construction: See Figure 1

The Jainsons Model UTD Test and Drain allows for draining of a sprinkler system as well as performing the required Water Flow Test with one combined valve incorporating a single handle. The UTD eliminates the need to utilize two separate valves and additional fittings to perform the test and drain functions. The Jainsons Model UTD is equipped with a test orifice K-Factor of 2.8 (40.3 metric). As such, the Model UTD is UL Listed for, and meets the NFPA 13 requirement of providing a flow equal to or less than the smallest orifice sprinkler on the system, when no installed sprinkler is smaller than a K 2.8 (40.3 metric). These features of the Model UTD reduce the need for additional Test and Drain Valve inventory with multiple test orifices.

The Model UTD contains two integrated ports with clear Lexan plugs allowing for a visual means to determine if water is flowing through the valve. A third port is available for the drain connection of an optional pressure relief valve. The Jainsons Model UTD comes in threaded end connections for sizes 3/4" through 2" and also grooved end connections for sizes 1 1/4" through 2".

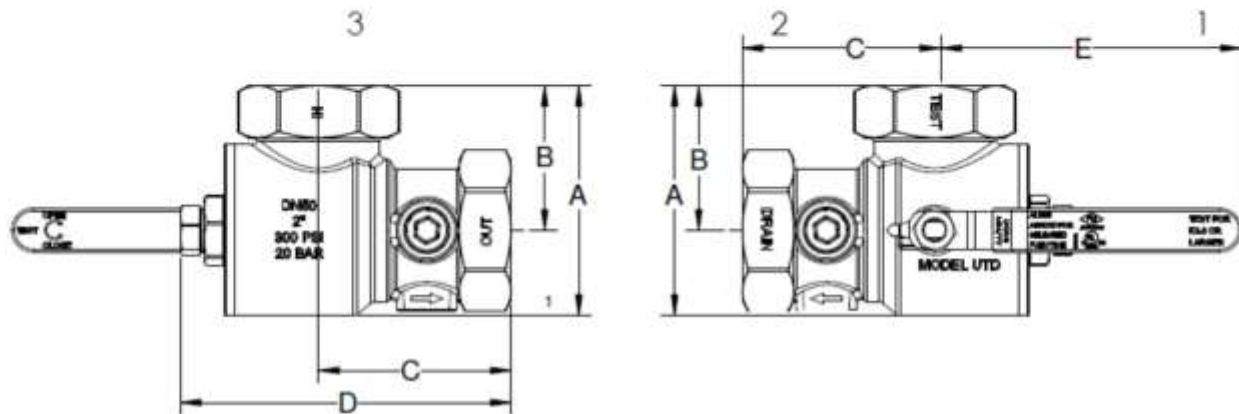


FIGURE 1 : MODEL UTD MATERIALS OF CONSTRUCTION



ITEMS NO.	DESCRIPTION	MATERIAL	QTY.
1.	1/2-14 NPT PIPE PLUG	STEEL	1
2.	3-WAY TEST AND DRAIN BODY	BRONZE	1
3.	UTD TEST AND DRAIN BALL	STAINLESS STEEL	1
4.	UTD TEST AND DRAIN HANDLE STEM	STAINLESS STEEL	1
5.	3-WAY TEST AND DRAIN STEM O-RING	EDPM	2
6.	3-WAY TEST AND DRAIN COVER	BRONZE	1
7.	UTD TEST AND DRAIN TEFLON SEAL	TEFLON	2
8.	SIGHT GLASS	LEXAN	3
9.	3-WAY RED HANDLE	EDPM	1
10.	RETAINING NUT	STAINLESS STEEL	1

FIGURE 2 : MODEL UTD INSTALLATION DIMENSIONS



Valve Size NPT	Nominal Installation Dimensions Inches (mm)				
	A	B	C	D	E
1" (DN25)	3.22 (82)	2.42 (61)	2.62 (67)	5.29 (134)	4.16 (106)
2" (DN50)	4.41 (112)	2.83 (60)	3.78 (96)	6.72 (159)	6.02 (153)

MODEL UTD CARE AND MAINTENANCE

The Jainsons Model UTD Test and Drain does not require any regularly scheduled maintenance.

System testing in accordance with NFPA 25 or other applicable Standard shall be followed to insure the in-tegrity of the entire system, including alarm functions as well as other system components.

The following procedures shall be performed, as needed, to conduct a waterflow alarm test of the flow switch, a drain test to verify adequate water supply, or to drain a section of the sprinkler system.

Where impairments or deficiencies are found, they must be corrected in accordance with NFPA25 or other applicable Standard.

When conducting a Waterflow Alarm Test, Flow Test (Main Drain Test), or draining of the system, position arrow (opposite the handle location near the stem of the valve) to the appropriate labeled function on the body of the valve.

ORDERING INFORMATION

MODEL UTD TEST AND DRAIN

Specify : MODEL UTD TEST AND DRAIN, TXT,

SIZE (1", 2") PN :

1" (DN25)

2" (DN50)

NOTE : Metric threads for the inlet and outlet of the valve are available upon request. Inform Customer Service at time of order.

1. Ductile Iron ASTM A536:

Ductile Iron Body, Bonnet, Wedge and Hand wheel, high strength and corrosion resisting. Valve seat was cast with body at the same time, not necessary to machine.

2. Triple O-ring Stem Seals:

The lower O-ring isolates the stem thrust collar bearing area from the waterway. The upper two O-rings can easily be replaced in the line while the valve is under pressure in the open position.

3. Bonnet Gasket:

Provides superior bonnet seal. (2-12")

4. Stainless Steel Stem and Brass Thrust Collar:

This time-tested design has repeatedly proven its superior strength over cast stems.

5. Fusion Bonded Epoxy Coating:

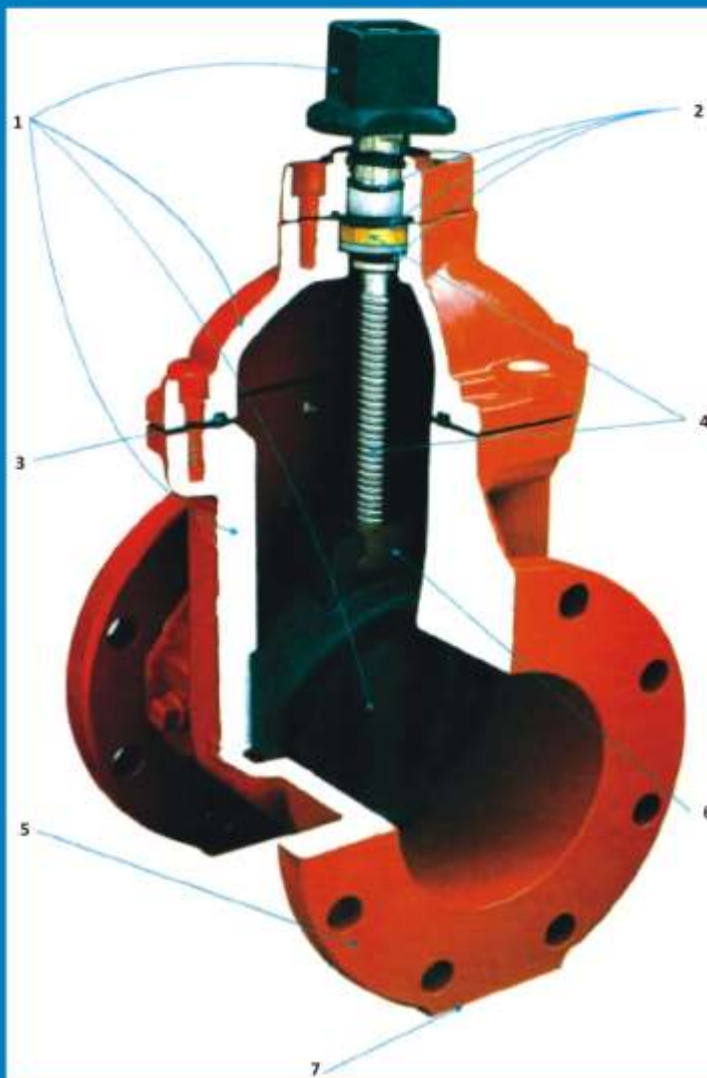
Inside and Outside, can be used for potable water, food and pharmaceuticals industry with long life.

6. Bronze Wedge Nut:

The nut is electrically isolated from the iron in the wedge for corrosion resistance. The nut is held tightly in place to resist stem binding.

7. Integral Legs:

Flats cast in the bottom of the valve body let the valve stand upright during stocking and installation.



JAINSONS INDUSTRIES

BASTI BAWA KHEL, KAPURTHALA ROAD,
JALANDHAR - 144 021 (Pb.) INDIA.

Ph.: +91-181-5093433, 2651431, 2651733 Fax: +91-181-2650642

Web: www.jainsonsindustries.com / www.pipefittings.in

Email: info@jainsonsindustries.com, jsi@vsnl.com